

Metalized Filled Silicone (5000 Series)

Product Summary

Metalized Filled Silicone is a molded silicone elastomer filled with conductive inert particles. It provides high electrical conductivity, broadband shielding and moisture sealing. MAJR offers these elastomers filled with: Nickel Graphite (52), Nickel (60), Silver-Plated Glass (61), Silver-Plated Aluminum (62), Silver Aluminum (63) Floro-Silicone Aluminum (64), Silver-Plated Nickel (65), Silver (66). Metalized Filled Silicone is designed to provide reliable and cost-effective shielding for a wide range of EMI applications. Metalized Filled Silicone is manufactured in sheets, molded parts, strips and die-cut flat gaskets.

Product Application

Metalized Filled Silicone should be used where there is a need for high broadband shielding combined with excellent moisture-sealing properties.

In order to assure electrical conductivity and sealing reliability, recommended design compression is 7% - 15% of original height for sheets and rectangular strips. For "O" and "D" shapes the recommended compression is 12% - 30%.

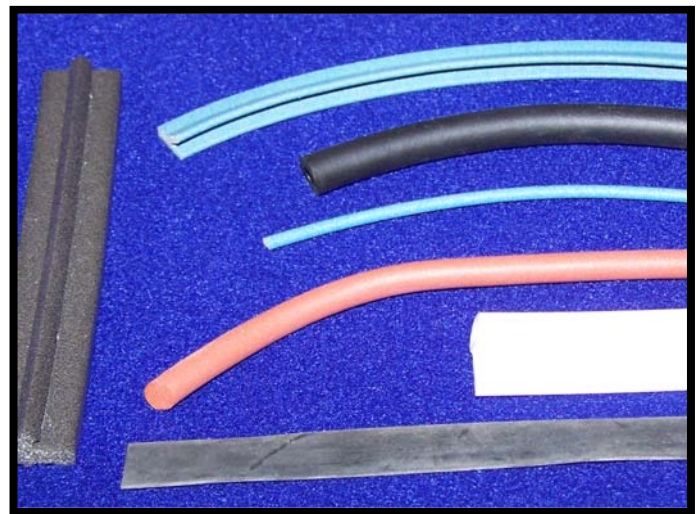

Adhering and Joining

For adhering Metalized Filled Silicone gaskets to enclosures, MAJR recommends a two-component, electrically conductive, silver silicone adhesive sealant of medium viscosity. This adhesive provides a flexible bond and a resilient seal. If necessary, MAJR can provide this sealant with your order; ask your representative. MAJR also offers "in house" vulcanization for any splicing and joining of our extruded or die cut conductive silicone and fluorosilicone parts.

Product Technical Data

Table 1
Specifications: Material Description

Metalized Filled Silicone	
Elastomer Binder:	Silicone
Conductive Filler:	Nickel Graphite (52)
	Nickel (60)
	Silver-Plated Glass (61)
	Silver-Plated Aluminum (62)
	Silver Aluminum (63)
	Floro-Silicone Aluminum (64)
	Silver-Plated Nickel (65)
	Silver (66)
Color:	Tan (Other colors available upon request)
Form Available:	Molded Sheets & Strips

Table 2
Specifications: Performance Characteristics

Data	Typical Values
Shore A	58-72
Tensile psi	200
Elongation %	200
Tear "B" ppi	35
Specific Gravity	1.7 - 2.2
Volume Resistivity	.005
Compression Set %	35
Compression/Deflection %	3.5
Temperature Range °C	-55 + 160

Metalized Filled Silicone (5000 Series) (Cont.)

Table 2 - Standard Sheets: (Other Sizes Available)

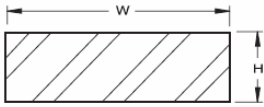

Height	Part Number	Standard Size
.020 [0.51]	5000-02000-xx	15" x 20" [305 mm square]
.032 [0.76]	5000-03000-xx	12" Square [305 mm square]
.040 [1.02]	5000-04000-xx	12" Square [305 mm square]
.062 [1.57]	5000-06000-xx	12" Square [305 mm square]
.093 [2.36]	5000-09000-xx	12" Square [305 mm square]
.125 [3.18]	5000-12000-xx	12" Square [305 mm square]

* Other sheet sizes available upon request.

Table 3 - Standard Rectangle:

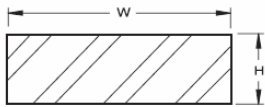

Height	.125 [3.18]	.188 [4.78]	.250 [6.35]	.375 [9.53]	.500 [12.70]
	Part Number	Part Number	Part Number	Part Number	Part Number
.032 [0.76]	5010-03012-xx	5010-03019-xx	5010-03025-xx	5010-03038-xx	5010-03050-xx
.062 [1.57]	5010-06012-xx	5010-06019-xx	5010-06025-xx	5010-06038-xx	5010-06050-xx
.093 [2.36]	5010-09012-xx	5010-09019-xx	5010-09025-xx	5010-09038-xx	5010-09050-xx
.125 [3.18]	5010-12012-xx	5010-12019-xx	5010-12025-xx	5010-12038-xx	5010-12050-xx
.188 [4.78]	5010-18012-xx	5010-18019-xx	5010-18025-xx	5010-18038-xx	5010-18050-xx
.250 [6.35]	5010-25012-xx	5010-25019-xx	5010-25025-xx	5010-25038-xx	5010-25050-xx

Table 4 - Standard "D" Shapes

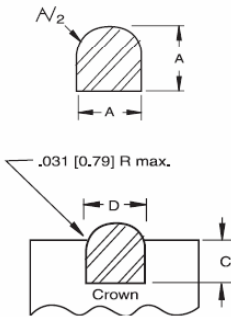

A Dimension	Part Number	Groove Dimensions	
		C +.006 -0 [0.15]	D +.006 -0 [0.15]
.062 [1.57]	5009-06005-xx	.046 [1.17]	.103 [2.65]
.093 [2.36]	5009-09007-xx	.071 [1.80]	.137 [3.50]
.125 [3.18]	5009-12010-xx	.096 [2.44]	.188 [4.75]
.188 [4.78]	5009-18015-xx	.146 [3.17]	.256 [6.50]
.250 [6.35]	5009-25020-xx	.199 [5.05]	.336 [8.55]

Table 5 - Standard Round:

Diameter	Part Number
.062 [1.57]	5011-06000-xx
.093 [2.36]	5011-09000-xx
.125 [3.18]	5011-12000-xx
.188 [4.78]	5011-18000-xx
.250 [6.35]	5011-25000-xx

**Figure 3
Compression and Deflection Data:**

Compression/Deflection Curve

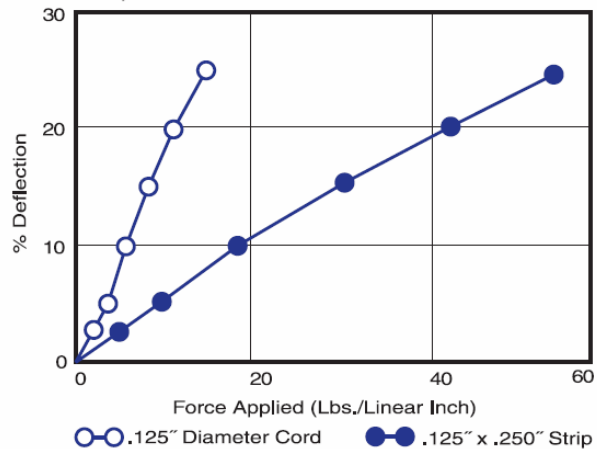

Ordering Information:

Replace xx with the appropriate material code:
 Nickel Graphite (52)
 Nickel (60)
 Silver-Plated Glass (61)
 Silver-Plated Aluminum (62)
 Silver Aluminum (63)
 Floro-Silicone Aluminum (64)
 Silver-Plated Nickel (65)
 Silver (66)

For cross-sections not listed above and custom design applications and molded parts, contact your MAJR representative.

Metalized Filled Silicone (5000 Series) (Cont.)

EMI Shielding Performance*

MAJR's Metallized Filled Silicone Shielding Effectiveness has been tested in accordance with MAJR's Test Methods and based upon modified MILSTD-285. Typical Shielding effectiveness values are based on a 5" square aperture. MAJR's Metallized Filled Silicone Shielding Effectiveness has been tested in accordance with the test method described in paragraph 4.5.12 of MIL-DTL-83528. Typical values are shown:

Table 3

H-Field 100 kHz	E-Field 10MHz	Plane Wave	
		1GHz	10GHz
dB	dB	dB	dB
105	110	120	110

*Silver Material (66)